

TOEPASSING VAN AFWERKENDE MESH TAPE - APPLICATION OF FINISHING MESH TAPE -
 APPLICATION DE LA BANDE DE RENFORT D'ANGLE - APLICACION DE LA MALLA PARA JUNTAS

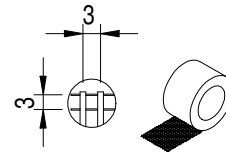
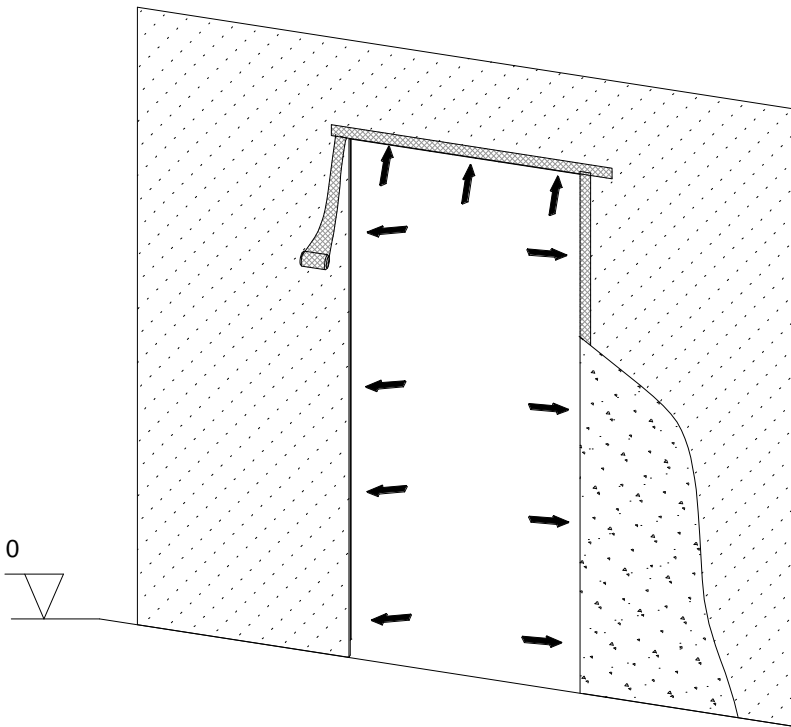

E - ~~BR~~ Breng de wapeningsstrip aan in de uitrusting voordat u gaat pleisteren

EN - ~~BE~~ Apply the fiber net 3x3 supplied before finishing

FR - ~~BE~~ Appliquer la bande de renfort en équipement avant de plâtrer

ES - Aplicar la red de refuerzo suministrada antes de la aplicación del mortero

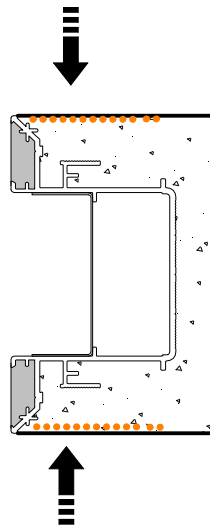
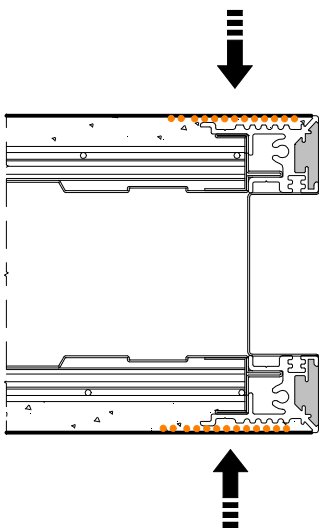

FR - ~~BE~~ Mezelversterkte voegvulling voor de perimeterzone kan raadzaam zijn

EN - ~~BE~~ Fiber-reinforced joint filler for the perimeter zone can be advisable

FR - L'enduit de rebouchage fibré est particulièrement approprié au périmètre

ES - Resulta especialmente apropiado el uso de masilla reforzada en el perímetro

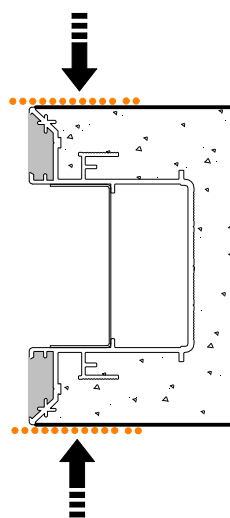
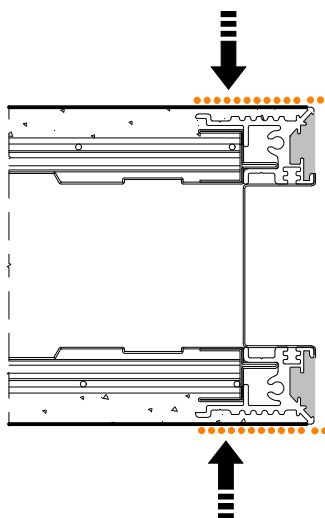

TINTEGGIATURA TELAIO - SYSTEM PAINTWORK -
PEINTURE CHASSIS - PINTURA BASTIDOR -

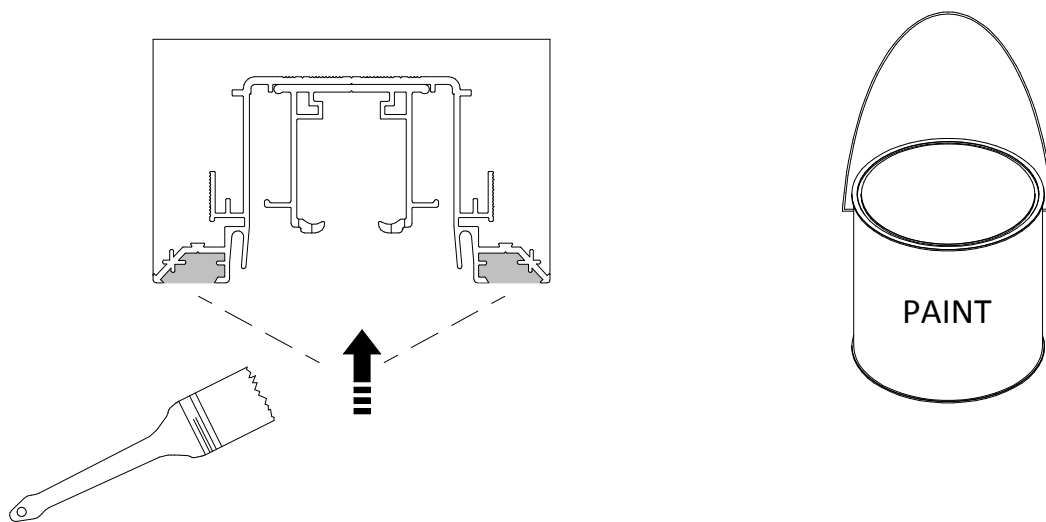
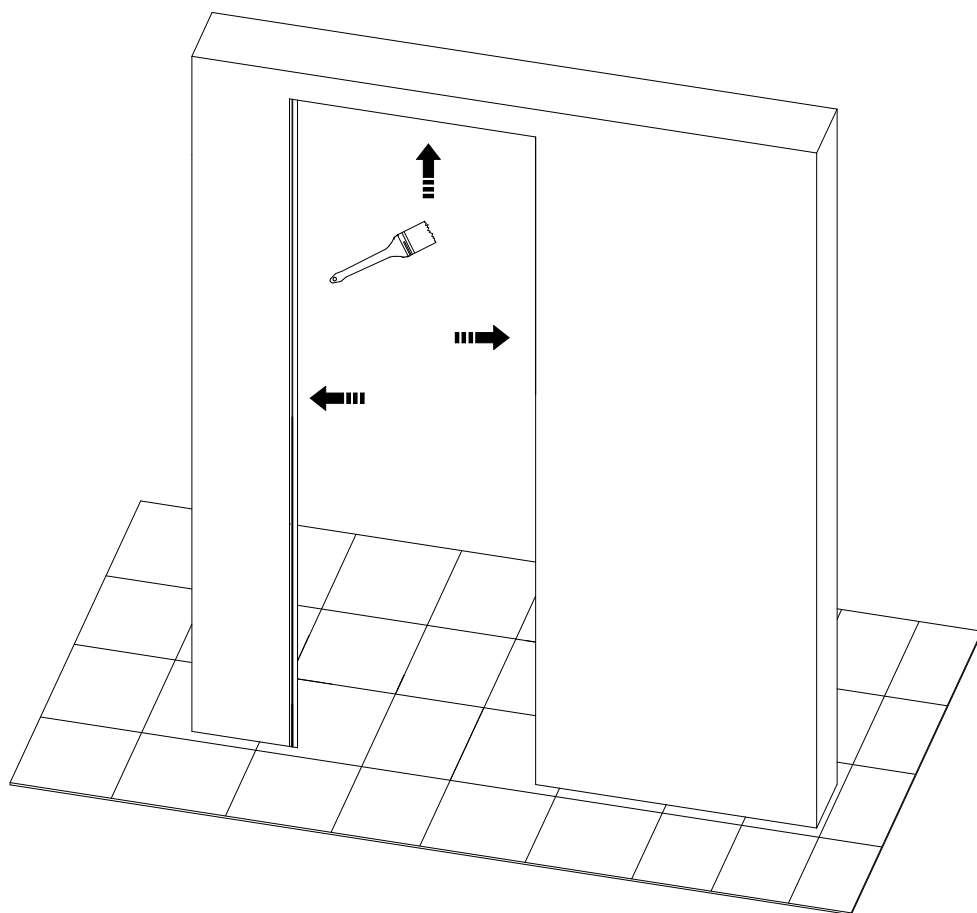

Ermetika
LIVE YOUR SPACE



+39 0883 535781



tecnico@ermetika.it



www.ermetika.it